

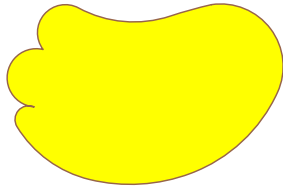

C07

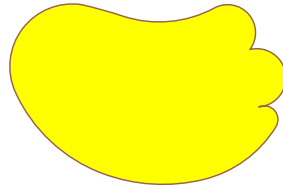

C08



E09

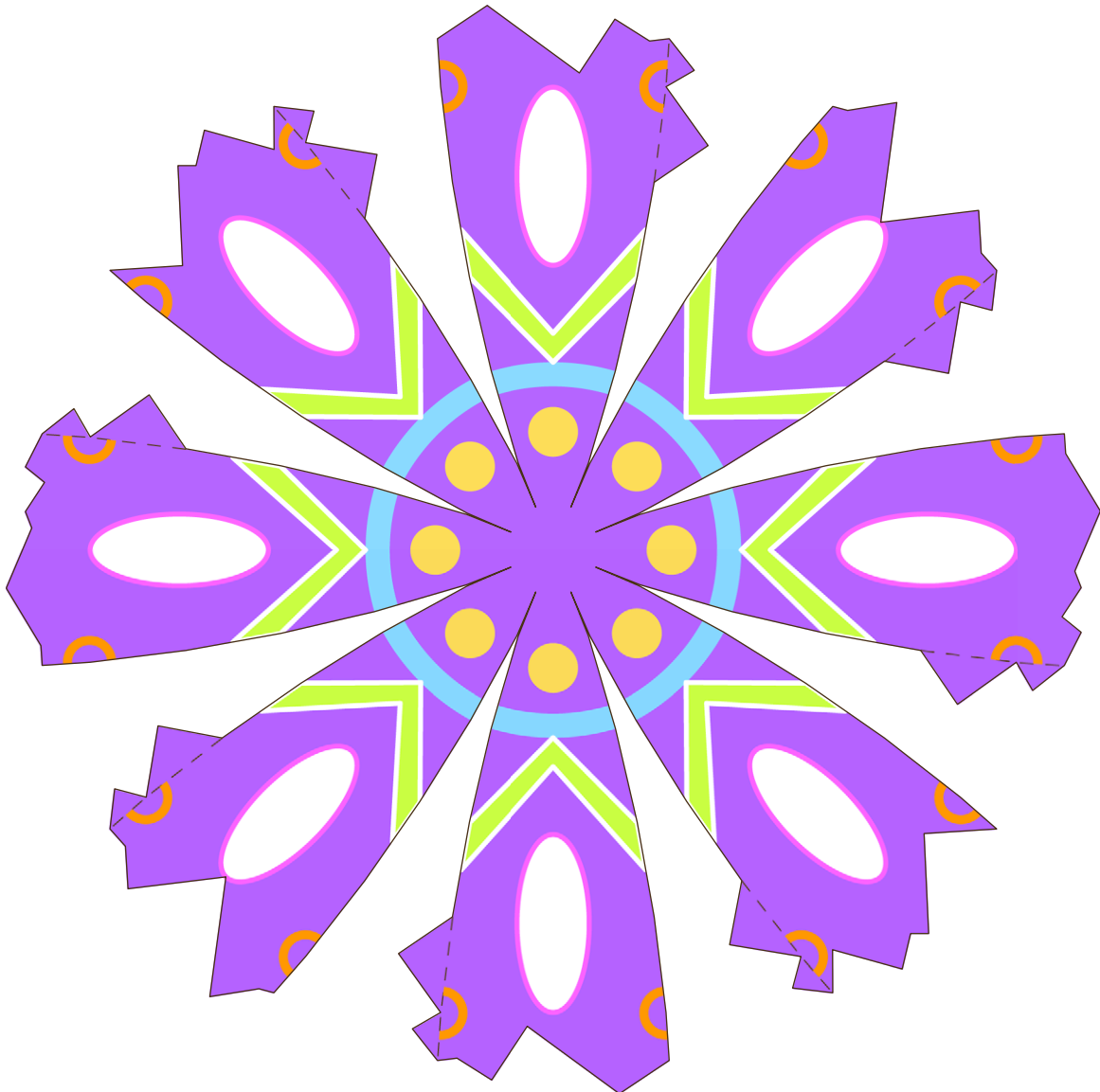



E10

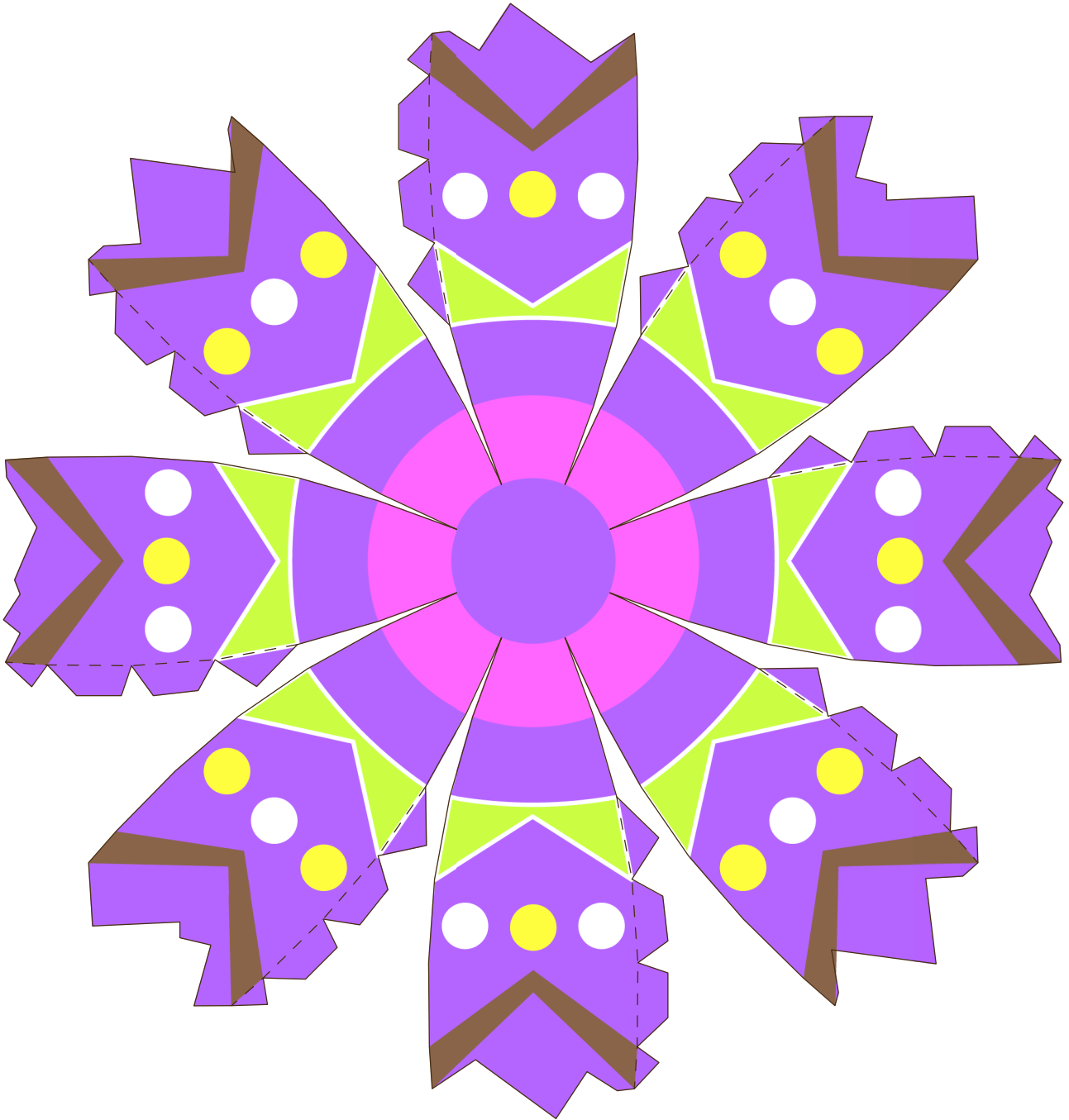

組合說明

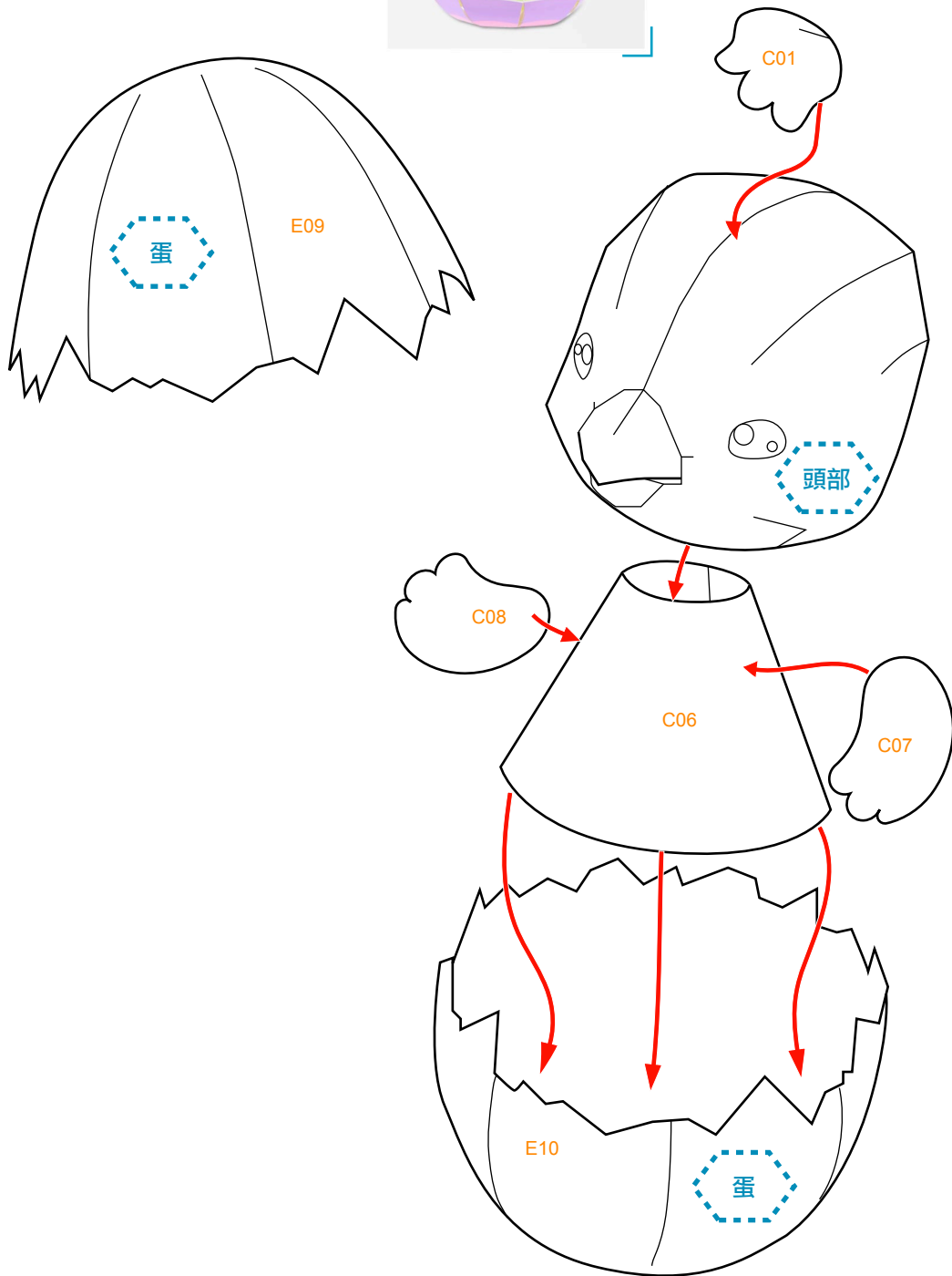
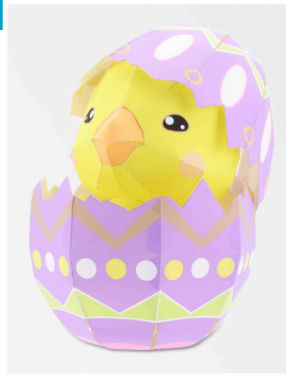
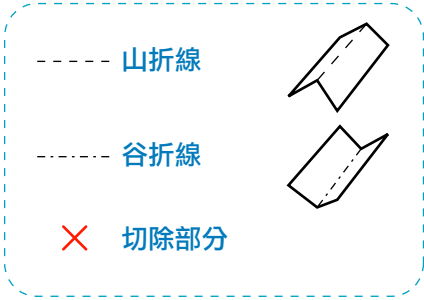

基本步驟



用沒有墨水的原子筆或鐵筆劃一下摺線。

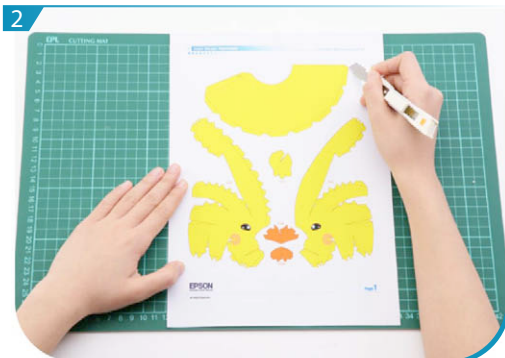

沿線剪出所有組件。為免混淆，可先在組件背面劃上記號。

蛋

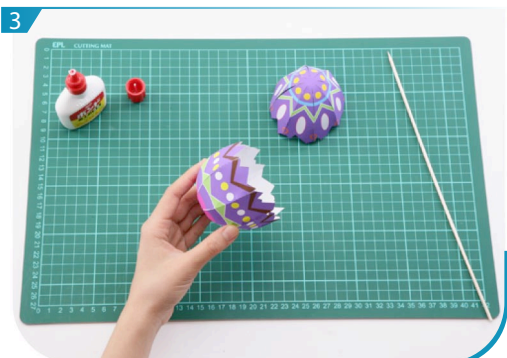

將E09及E10各自摺疊貼好。

身體

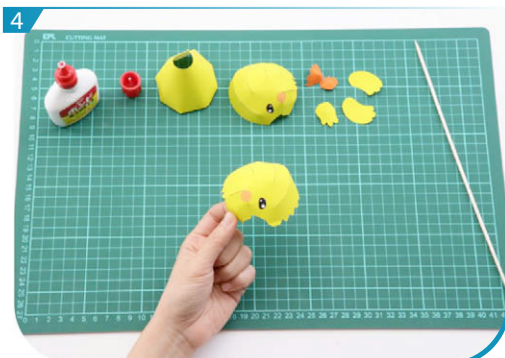

將C01至C06各自摺疊貼好。

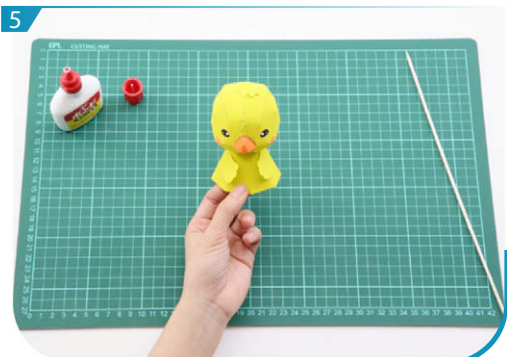

將C01至C08按組合說明貼好，雞仔完成。

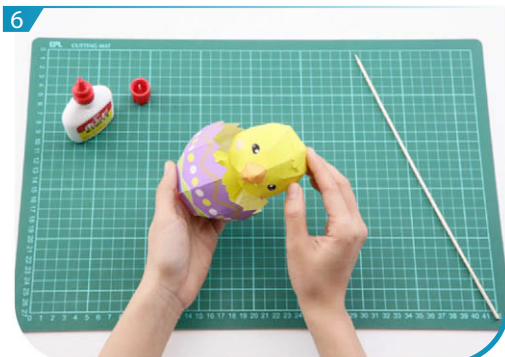

最後，將雞仔貼於蛋內。